

# TAKSTAR® 得胜



**M-2R** | 真分集无线麦克风  
True Diversity Wireless Microphone

使用手册 | User Manual

## ■ 前言

尊敬的用户：

感谢您选购得胜M-2R 真分集无线麦克风，为了您能够更好的了解使用本产品，建议您在使用前仔细阅读本说明书。

若存在有疑问或者您有宝贵的建议，可通过拨打得胜官方服务热线400 6828 333或微信扫描二维码关注得胜官方公众号与我们联系。



## ■ 产品特性

- TUNER真分集自动接收技术，提高接收能力；
- VA LCD 显示工作信息，人机对话一目了然；
- 预设8组，每组12个互不干扰通道,方便用户安装；
- 具有自动搜寻功能，可快速锁定干净频道；
- 设有SQ功能,可改变接收灵敏度阈值，提高抗干扰能力；
- XLR和6.3音频输出接口,方便用户连接下级设备；
- 接收机可搭配得胜天线系统，提高接收距离和加强信号的稳定性。

## ■ 包装清单

接收机.....	1台
音频连接线.....	1条
电源适配器.....	1个
角码 .....	2个
天线 .....	2条
5号电池.....	4颗
说明书.....	1份
手持麦克风.....	选配
腰挂式领夹麦克风.....	选配
腰挂式头戴麦克风.....	选配

## ■ 技术参数

### 系统指标:

频率范围: 470~960 MHz(分段设计)

通道数量: 两通道

信道数量: 700

频率宽度: 30MHz

调制方式: FM

静音控制: 导频

调制频偏:  $\pm 48\text{KHz}$

频率响应: 50~18000Hz

频率精度:  $\pm 15\text{KHz}$

动态范围:  $\geq 95\text{dB A+}$

信噪比:  $\geq 100\text{dB A+}$

失真度:  $\leq 1\%$  (at 1KHz)

使用距离: 100米

### 手持发射机:

供电方式: 2节AA电池

发射功率:  $\leq 10\text{mW}$

显示方式: LCD显示频道、电量信息

振荡方式: PLL数字锁相环

使用时间: 大于8小时

尺寸(DxH): 54x260 mm

重量: 约345g

### 接收机:

接收方式: 双调谐自动选讯

振荡方式: PLL数字锁相环

显示方式: VALCD显示屏

供电方式: DC12V  $\approx$  1000mA

天线接口: BNC/50欧,

DC10~12V  $\approx$  30mA(max.)

接收灵敏度:  $\leq -85\text{dBm}$  (接线测试)

音频输出方式: XLR插座和6.3mm插座

接收机尺寸(LxWxH): 400x42 x183mm

接收机重量: 约 1720 g

### 腰挂发射机:

频道设定: SYNC自动锁频

显示方式: LCD显示频道、电池信息

振荡方式: PLL数字锁相环

供电方式: 2节AA电池

发射功率:  $\leq 10\text{mW}$

使用时间: 大于8小时

尺寸(WxLxH): 66x97x25 mm

重量: 约86g

注: 以上数据由得胜实验室测得并拥有最终解释权。

## ■ 适用范围

演出、婚庆活动、学校、教堂

## ■ 功能示意

### 接收机

#### 正面板：

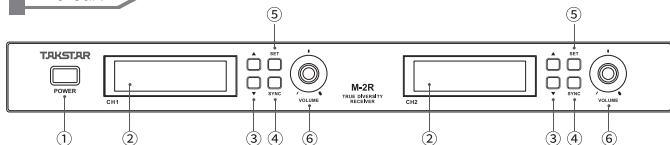

- ① 电源开关
- ② LCD 液晶屏幕: 显示频道、频率及各项设定
- ③ ▲▼: 选择频道
- ④ SYNC: 同步对频
- ⑤ SET: 扫描/默认模式
- ⑥ 音量: 调整接收机的输出音量

#### 背面板：

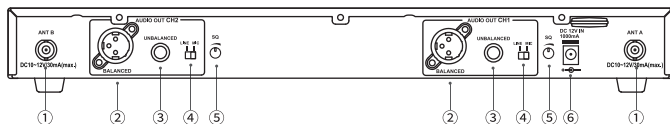

- ① 天线孔
- ② 平衡式XLR输出孔
- ③ 不平衡式6.35mm输出孔
- ④ MIC/LINE 切换键: 切换MIC LEVEL (-20dB) 或LINE LEVEL (0dB)
- ⑤ SQ静噪旋钮: 调整接收机灵敏度阈值
- ⑥ 直流电源输入插孔

## LCD 液晶屏幕

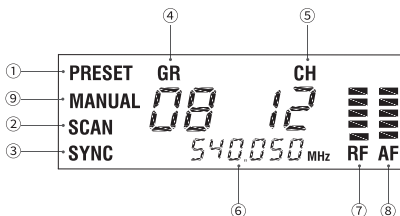

- ① PRESET: 可预设8组群组
- ② SCAN: 扫描可用频道
- ③ SYNC: 启动同步对频
- ④ GR: 显示默认群组
- ⑤ CH: 在“PRESET”模式, 显示默认频道  
CH: 在“SCAN”模式, 显示频道号码
- ⑥ FREQ: 显示当前频率
- ⑦ RF 指示: 显示RF信号接收强度
- ⑧ AF 指示: 显示AF信号动态
- ⑨ MANUAL: 手动调整频道

## 手持发射机

- ① 网头: 保护音头并降低POP声及风声
- ② SYNC: 按下后与接收机进行对频
- ③ Talk: 向上推开启, 向下推静音
- ④ 电池槽: 依正负极方向装入两颗AA电池
- ⑤ 电源开关: 长按2秒开启或关闭电源
- ⑥ LCD 屏幕: 显示频道和电池电量
- ⑦ 电量指示灯:

LED电力指示灯	状态说明
绿灯	电力充足
闪烁绿灯	同步配对进行中
闪烁红灯	电池电力剩余不到10分钟

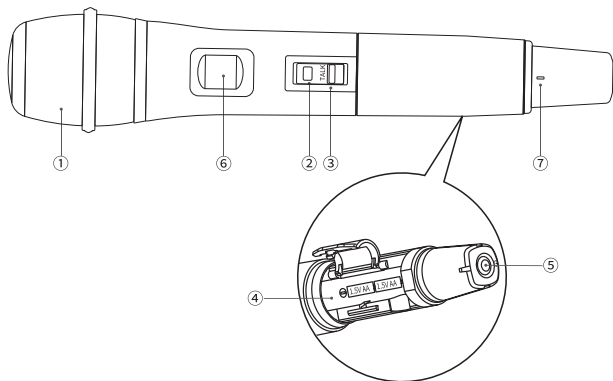

### 腰挂发射机

- ① 电源开关：长按2秒开启或关闭电源
- ② 静音键：切换静音与正常模式
- ③ 增益切换：切换输入-20dB/-10dB/0dB
- ④ 静音LED指示灯：静音状态显示蓝灯
- ⑤ SYNC：按下后与接收机进行对频
- ⑥ LCD 屏幕：显示频道号码和电池电量
- ⑦ 电池槽：依正负极方向装入两颗AA电池
- ⑧ Mini XLR 插孔：连接领夹型麦克风或头戴式麦克风
- ⑨ 电量指示灯：

LED电力指示灯	状态说明
绿灯	电力充足
闪烁绿灯	同步配对进行中
闪烁红灯	电池电力剩余不到10分钟

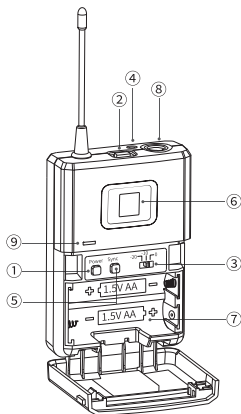

### ■ 使用说明

#### ● 配对接收机

在开始设定前请先检查发射器和接收机是否对到相同频率或频道；

相同频率下无法同地同时操作两组或以上发射器。

1. 将电源供应器插入插座，另一端插入背板的DC 12V插孔，LCD屏幕会亮起，表示电源已开启；
2. 插入标准 3 PIN XLR平衡接头或6.3 mm不平衡接头连接下一级音频设备（如混音器或扩音器）；请勿同时接上平衡与不平衡接头输出，可能导致信号损耗或增加噪音；
3. MIC/LINE切换  
MIC: -20dB  
LINE: 0dB (默认值)
4. 调整音量旋钮以控制下一级音频设备（如混音器或扩音器）；  
默认值：最小音量；
5. 调整SQ旋钮以消除或抑制RF噪音；默认值：适当。

#### ● 设定接收机上的频道

注意:设定频率时请勿让两台或以上的发射器靠近彼此;请保持1米以上的距离。

##### 一：扫频模式

此模式中系统会扫描可用频道

1. 按下“SET”键0.5秒后，任一功能文字“PRESET”、“SCAN”、“MANUAL”将会闪烁；
2. 按下“△”或“▽”键，选择“SCAN”之功能文字；
3. 按下“SET”键，“SCAN”文字将停止闪烁，同时GR及CH下方数字闪烁；
4. 按下“△”或“▽”键时，系统将会扫描，并选择一组不受干扰之频段数字而闪烁；
5. 按下“SET”键，GR及CH下方数字将停止闪烁并完成“SCAN”功能操作；

6. 如果按下“△”或“▽”键，系统于GR及CH状态下选不到适用之频道，系统将改为自动扫描全频段之适用频道；

7. 按下“SET”键，GR及下方数字将停止闪烁，完成“SCAN”功能操作。

注意：如用户须设定多组接收机系统，请将已配对好的接收机和发射器保持开启，再继续其他组的配对。

### 二：默认模式

设定多组频道，共可设定8个群组，每个群组内有12个频道可同时操作，互不干扰

1. 按下“SET”键0.5秒后，任一功能文字“PRESET”、“SCAN”、“MANUAL”将会闪烁；

2. 按下“△”或“▽”键，选择“PRESET”之功能文字；

3. 按下“SET”键，“PRESET”文字将停止闪烁，同时GR及下方数字闪烁；

4. 按下“△”或“▽”键时，选择GR下方数字到所要选定之数字；

5. 按下“SET”键，GR及下方数字将停止闪烁，同时CH及下方数字闪烁；

6. 按下“△”或“▽”键，选择CH下方数字到所要选定之数字；

7. 按下“SET”键，CH及下方数字将停止闪烁，完成“PRESET”功能操作。

注意：如目前使用的群组出现外部信号干扰，请使用其他群组；如8组群组全都产生信号干扰，请选择扫频模式重新设定。

### 三：手动调整模式

1. 按下“SET”键0.5秒后，任一功能文字“PRESET”、“SCAN”、“MANUAL”将会闪烁；

2. 按下“△”或“▽”键，选择“MANUAL”之功能文字；

3. 按下“SET”键，“MANUAL”文字将停止闪烁，同时频道与频率数字闪烁；

4. 按下“△”或“▽”键时，选择频道与频率数字到所要选定之数字；

5. 按下“SET”键，频道与频率数字将停止闪烁。

### ● 设定手持麦克风和腰挂麦克风

1. 打开电池盖后依正负极方向装入电池；
2. 逆时针方向旋开麦克风握把盖后打开电池槽外盖，依正负极方向装入电池；
3. 接上领夹式麦克风、头戴式麦克风或吉他线；
4. 长按2秒开启手持麦克风或腰挂发射器；如LED灯持续闪烁，表示电池电量不足需更换；
5. 音源输入增益设定
  - 0dB
  - -10dB (默认值)
  - -20dB

注意：如长时间不使用，请关闭电源节电。

### ● 头戴麦克风佩戴方法

1. 佩戴头戴麦克风，将耳挂水平佩戴在耳朵上，并将弹力带调整于头部后方，如图所示；



2. 可根据个人实际佩戴情况，调节弹力带松紧程度，调整至与头部贴合即可；
3. 建议将麦克风与嘴部距离保持2-3cm，并与嘴角保持45°，如图所示；



## ● 接收机和发射器对频

自动同步配对频道，设定简单

1. 首先开启发射器和接收机电源，按住发射器的SYNC键，接收机上的屏幕会闪烁，此时按住接收机上的SYNC键，锁定选定的频道发送给发射器；
2. 对频设定时，发射器和接收机的距离需在1米内。

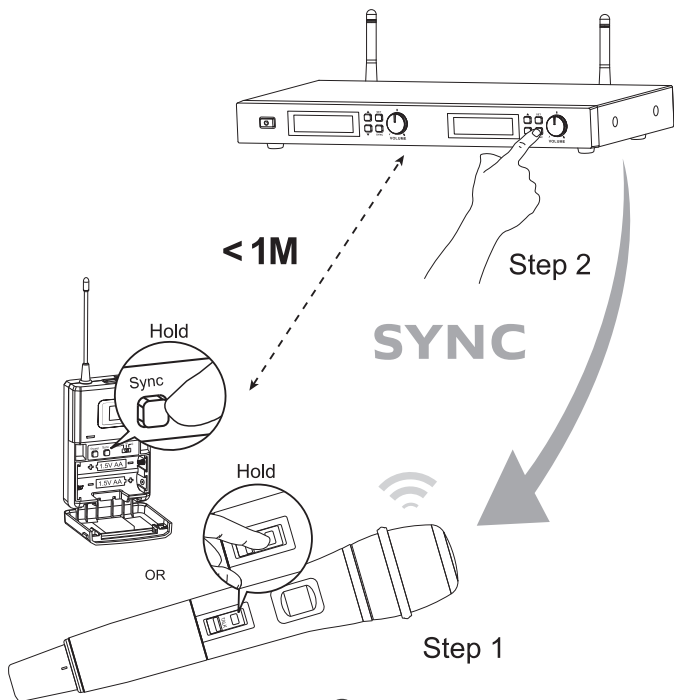

### 注意事项

- ① 接收机采用全向天线时, 天线离墙体 (特别是金属体) 应有0.5米距离;
- ② 接收范围和很多因素相关, 变化很大, 在传输方向无大型金属件阻挡, 可以获得更好的传输效果;
- ③ 如果接收条件不够理想, 可以采用延长线, 外接高增益天线, 甚至天线放大器, 可以达到非常明显的增距效果;
- ④ 当接收机面板正对使用方向时, 或接收机内置在金属箱体内时, 将天线接于前面板会有更好的接收效果;
- ⑤ 发射机使用中出現红灯或绿灯闪烁时, 表示电池电量不足, 需更换电池;
- ⑥ 若发射机长期不使用时, 请从底座内取出电池, 以免电池漏液而损坏麦克风;
- ⑦ 正确的调整发射器咪头与嘴的距离, 太近会引起调制过大而产生信号失真, 太远的灵敏度使调制度不够, 将会降低信噪比。建议嘴巴距咪头约5~15厘米。

### 故障现象/故障原因

故障现象	故障原因
发射器、接收机无指示	发射器电池耗尽, 接收机电源未接好
接收机无射频信号	收发不同频或超出接收范围
有射频信号, 但无音频信号	发射器麦克风未接入或接收机静噪太深
音频信号背景噪声太大	发射调制频偏太小, 接收输出电平低。 也许有干扰信号
音频信号失真	发射器的咪头与嘴巴距离太近, 接收机输出电平过高
使用距离较短, 信号不稳定	接收机静噪太深, 接收机天线设置不当, 周围有强电磁干扰

如果出现的故障不包含在上表, 切勿自行拆开修理, 请联系厂家或当地经销商!

### ■ 安全警告

为避免电击、高温、着火、辐射、爆炸、机械危险以及使用不当等可能造成的人身伤害或财产损失，使用本产品前，请仔细阅读并遵守以下事项：

1. 使用产品时请确认所连接设备与本产品功率是否匹配以及合理调整音量大小，不要在超过产品功率及大音量下长时间使用，以免造成产品异常和听力损伤；
2. 使用中若发现有异常（如冒烟、异味等），请立即关闭电源开关并拔掉电源插头，然后将产品送经销商检修；
3. 若产品需要使用可拆装电池时，严禁使用外壳绝缘材料破损的电池；请不要为非充电电池充电；
4. 废弃电池需放入指定的分类垃圾桶，不可作为儿童玩具或直接丢弃，以免造成安全隐患或影响环境；
5. 本产品及配件都应放置在室内干燥通风处，勿长期存放在潮湿、灰尘多的环境，使用中避免靠近火源、雨淋、进水、过度碰撞、抛掷、振动本机及覆盖通风孔，以免损坏其功能；
6. 若产品需要固定于墙壁或天花板上时，请确保固定到位，防止因固定强度不足导致产品发生跌落危险；
7. 使用该产品时需遵守相关安全规定，法律法规明确禁止使用场合请勿使用本机，以免导致意外事故；
8. 请不要自行拆机改装或维修，以防止出现人身伤害，如有问题或服务需求请联系当地经销商跟进处理。

## ■ 关于图标含义解释：



根据RL2004/108/EG和European Low Voltage Directive (欧洲低电压指令) RL2006/95/EG的测试结果表明, 本产品符合欧共体关于电磁兼容性的成员国法律整合的指令中所规定的限值。



此符号表示, 根据WEEE指令(2012/19/EU)和国家法律, 由于这种类型的废弃物会有潜在的有害物质, 可能对环境 and 人类健康产生负面影响, 所以本产品不应与您的家庭垃圾一起处置, 应将本产品交由授权的电气和电子设备(WEEE)回收站回收。同时, 您在正确处理本产品的同时将有助于自然资源的有效利用。如需了解更多有关您可以在何处放置废物回收设备的信息, 请联系您当地的城市办事处、废物管理局或家庭废物处理服务部门。

## ■ 环保说明

**产品中有毒有害物质或元素的名称及含量标识表**

部件名称	有毒有害物质或元素					
	铅 (Pb)	汞 (Hg)	镉 (Cd)	六价铬 (Cr(VI))	多溴联苯 (PBB)	多溴二苯醚 (PBDE)
塑料部件	○	○	○	○	○	○
金属部件	×	○	○	○	○	○
电路板组件	×	○	○	○	○	○
线缆	×	○	○	○	○	○

本表格依据SJ/T 11364的规定编制。

○: 表示该有害物质在该部件所有均质材料中的含量均在 GB/T 26572规定的限量要求以下。

×: 表示该有害物质至少在该部件的某一均质材料中的含量超出 GB/T 26572规定的限量要求。

此标志为产品的环保使用期限标志,  
且此标保使用期限只适用于产品正常工作的温度和湿度等条件。



## ■ Preface

Dear Customer,

Thank you for purchasing Takstar M-2R Dual Channel Wireless Receiver . Please read the user manual carefully before operation and keep it for reference in future.

If you have any question or suggestion, please contact our local dealer.

## ■ Features

- 1: Tuner true diversity technology improves receiving capability;
- 2: VA LCD intuitive display;
- 3: Preset 8 groups, each group has 12 non-interference channels for convenient installation;
- 4: Automatic search function for non-interference channel;
- 5: SQ function changes sensitivity threshold to improve anti-interference capability;
- 6: XLR and 6.3 connector for convenient connection;
- 7: The receiver can be used with Takstar antenna system to improve receiving range and signal.

## ■ Product content

Receiver .....	1pc
Audio cable.....	1pc
Power adapter.....	1pc
Corner .....	2pcs
Antenn .....	2pcs
AA battery .....	4pcs
User manual .....	1pc
Handheld microphone.....	optional
Lavalier microphone .....	optional
Headphone microphone.....	optional

## ■ Specification

### System Specification:

Frequency Range: 470~960 MHz(frequency band)

Channel Quantity: two channels

Frequency Band Quantity: 700

Frequency Width: 30MHz

Modulation: FM

Mute Control: frequency guide

Frequency Deviation:  $\pm 48\text{KHz}$

Frequency Response: 50~18000Hz

Frequency Accuracy:  $\pm 15\text{KHz}$

Dynamic Range:  $\geq 95\text{dB}$  A+

S/N Ratio:  $\geq 100\text{dB}$  A+

Distortion:  $\leq 1\%$  (at 1KHz)

Operation Range: 100M

### Receiver:

Receiving: dual modulation auto diversity

Oscillation: PLL

Display: VALCD

Power Supply: DC12V  $\approx$  1000mA

Antenna: BNC/50 $\Omega$ , DC10~12V  $\approx$  30mA(max.)

Receiving Sensitivity:  $\leq -85\text{dBm}$  ( wired during test)

Audio Output: XLR & 6.3mm connector

Receiver Dimension (LxWxH) : 400 x 42 x 183mm

Receiver Weight: 1720g approximate

### Handheld Transmitter:

Power Supply: two AA batteries

Transmission Power:  $\leq 10\text{mW}$

Display: LCD displays channel and power supply information

Oscillation: PLL

Operation Time: more than 8h

Dimension (DxH) : 54 x 260mm

Weight: 345g approximate

### Bodypack Transmitter:

Channel setting: SYNC automatic lock frequency

Display: LCD displays channel and power supply information

Oscillation: PLL

Power Supply: two AA batteries

Transmission Power:  $\leq 10\text{mW}$

Operation Time: more than 8h

Dimension (WxLxH) : 66 x 97 x 25mm

Weight: 86g approximate

Note: The above data are obtained by Takstar Laboratory and have the right of final interpretation has the right of final interpretation.

## ■ Application

Show, wedding, school, church

## ■ Function instruction

### Receiver

#### Front panel:

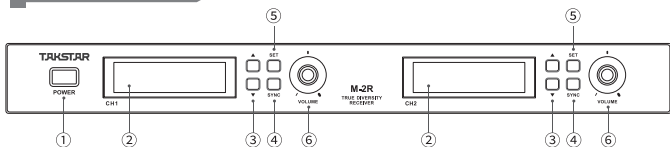

- ① Power switch.
- ② LCD: displaying channel, frequency and other setting.
- ③ ▲▼: selecting channel.
- ④ SYNC : matching frequency synchronically.
- ⑤ SET : scan/default mode.
- ⑥ Volume: adjusting receiver output volume.

#### Rear panel:

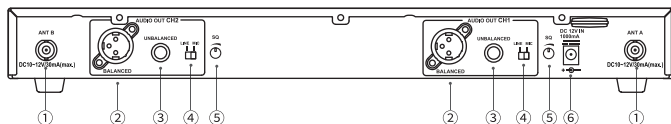

- ① Antenna connector.
- ② Bal XLR output connector.
- ③ Unbal 6.35mm output connector.
- ④ MIC/LINE : switching MIC LEVEL (-20dB) or LINE LEVEL (0dB) .
- ⑤ SQ knob: adjusting receiver sensitivity threshold.
- ⑥ DC input connector

### LCD Display:

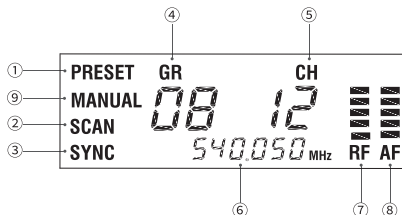

- ① PRESET : presetting 8 groups.
- ② SCAN : scanning the channel which can be used.
- ③ SYNC : starting the synchronized frequency matching
- ④ GR : displaying default group
- ⑤ CH : displaying default channel in PRESET mode.  
CH : displaying channel number in SCAN mode.
- ⑥ FREQ : displaying the current frequency.
- ⑦ RF meter: displaying RF signal level.
- ⑧ AF : displaying AF signal level.
- 9. MANUAL: adjusting channel manually.

### Handheld Microphone

- ① Grille: protecting the cartridge and reducing pop noise.
- ② SYNC : press it to match with receiver frequency.
- ③ Talk : push it upward to turn on and downward to mute.
- ④ Battery compartment: it loads two AA batteries.
- ⑤ Power switch: keep pressing it for 2 seconds to turn on or off.
- ⑥ LCD: it displays channel and battery power.
- ⑦ Power LED:

Power LED	Status instruction
Lighting up green	Sufficient power supply
Lighting up green flashing	during matching frequency status
Lighting up red flashing	battery power lasts for less than 10 minutes

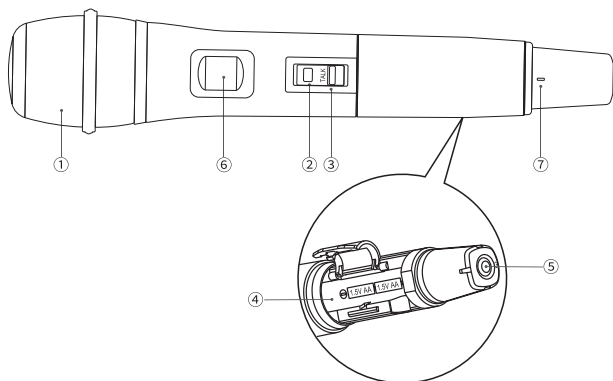

## Bodypack Microphone

- ① Power switch: keep press for 2 seconds to turn on/off.
- ② Mute button: switch mute or normal mode.
- ③ Gain: switching -20dB/-10dB/0dB input.
- ④ Mute LED: it lights up blue during mute status.
- ⑤ SYNC : press it to match the frequency with receiver.
- ⑥ LCD : it displays channel number and battery power.
- ⑦ Battery compartment: it loads two AA batteries.
- ⑧ Mini XLR connector: it links with lavalier microphone or headset microphone.
- ⑨ Power LED:

Power LED	Status instruction
Lighting up green	Sufficient power supply
Lighting up green flashing	during matching frequency status
Lighting up red flashing	battery power lasts for less than 10 minutes

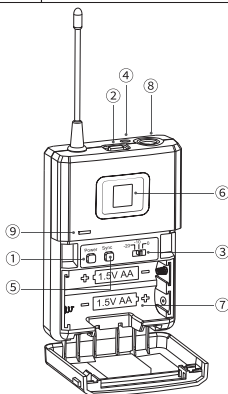

### ■ Operation instruction

#### Matching with receiver

Please check if the transmitter and receiver are matched to the same frequency or channel before matching.

Two groups of transmitters or more can not be operated simultaneously in the same place in the same frequency.

1. Connect the power supply with DC12V connector on the rear panel. LCD lights up. This means it is powered on.
2. Connect 3 PIN XLR bal connector or 6.3 mm unbal connector with the next audio equipment (e.g. mixer or amplifier). Do not connect bal and unbal output simultaneously. This leads to signal consumption or noise increasing.
3. MIC/LINE switching  
MIC: -20dB  
LINE: 0dB (default value)
4. Adjust volume knob to control the next audio equipment (e.g. mixer or amplifier).  
Default value: min volume
5. Adjusting SQ knob to eliminate or reject RF noise. Default value: proper.

#### Setting receiver channel

Note: Please do not put two or more transmitters closely during setting the frequency. Keep one transmitter away from the other one for more than one meter.

##### A. Scan mode

In this mode, the system will scan the channel which be used

1. Press Set button 0.5 second. The character PRESET or SCAN or MANUAL will flash.
2. Press “△” or “▽” button, and select “SCAN” function.

3. Press SET button. The character SCAN stops flashing. The number below GR and CH flashes.
4. Press “△” or “▽” button, and the system will scan and select the non-interference frequency. The frequency number flashes.
5. Press “SET” button. The number below GR and CH stops flashing. The system finishes SCAN operation.
6. Press “△” or “▽” button. If the system can not select the proper channel in GR and CH status, the system will scan all frequency band automatically and select the proper frequency.
7. Press “SET” button, GR and the number below stop flashing to finish SCAN operation.

Note: if you need to set multiple receiver systems, please keep matched receivers and transmitters powered on, and then match other systems.

### B. Default mode

Set multiple groups of channels, totally 8 groups, 12 channels of each group can be operated simultaneously without interference.

1. Press “SET” button 0.5 second. The character PRESET or SCAN will flash.
2. Press “△” or “▽” button, and select “SCAN” function.
3. Press SET button. The character SCAN stops flashing. The number below GR flashes.
4. Press “△” or “▽” button to select the number below GR to the wanted number.
5. Press “SET” button. GR and the number below stop flashing, and meanwhile CH and the number below flash.
6. Press “△” or “▽” button to select the number below CH to the wanted number.

7. Press “SET” button. CH and the number below stop flashing to finish “PRESET” function.

Note: if there is external signal interference in the present group, please use other group. If 8 groups have signal interference, please use scan mode to set again.

### C: Manual adjustment mode

1. Press SET for 0.5S, the function character PRESET or SCAN or MANUAL will flash.
2. Press “△” or “▽” button, select” MANUAL “.
3. Press “SET” button, and “MANUAL” stops flashing, and meanwhile, channel and frequency number flash.
4. Press “△” or “▽” button to select wanted number for channel and frequency.
5. Press “SET” button. Channel and frequency number stop flashing.

## Set handheld microphone and bodypack microphone

1. Open the battery compartment and load battery.
2. Turn the microphone end tube counterclockwise and open the battery compartment. Load in battery according to correct polar.
3. Connect with lavalier microphone, headset microphone or guitar cable.
4. Turn on the handheld microphone or bodypack transmitter. If the LED keeps flashing, this means insufficient battery power. Please replace the battery in time.
5. Audio input gain setting
  - 0dB
  - -10dB (default value)
  - -20dB

Note: if it will not be used for a long time, please turn off the power switch to save the power.

### ● Headworn mic wearing

1. Wear the headworn mic on head, and put the hook on ears, and adjust the elastic band. Refer to the figure.



2. Adjust the elastic band on head properly.
3. It is recommended to keep the mic 2-3cm away from your mouth and 45 degree to your mouth. refer to the figure below:



### Matching receiver and transmitter

Automatically matching the channels, easy setting

1. Turn on the transmitter and receiver at first. Press SYNC button of transmitter. The display of receiver flashes. Press SYNC button of receiver. It select the channel and send it to the transmitter.
2. The transmitter and the receiver should be kept in 1m range during matching.

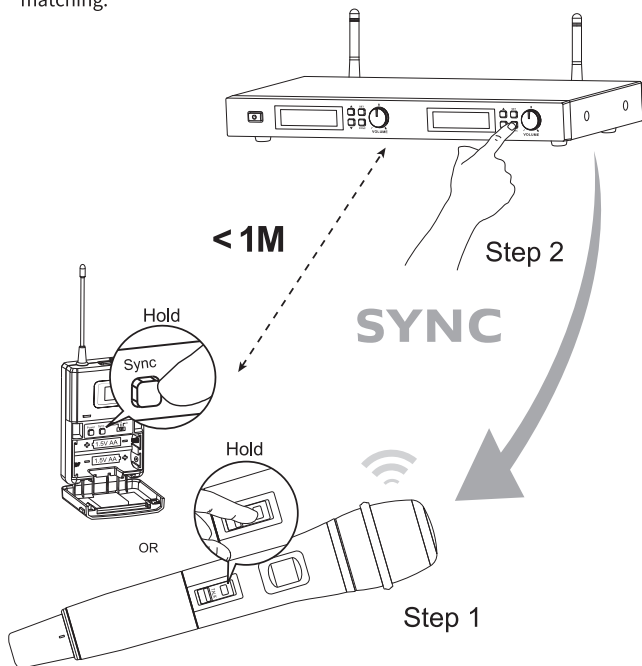

### Cautions

- ① If the omni-directional antenna is used for the receiver. Keep the antenna 0.5m away from the wall (especially metal object).
- ② The receiving range is relative to many factors. If there is no big metal part in the transmission direction, the transmission effect is better.
- ③ If the receiving condition is not so good, you can use the extension cable and external high gain antenna, or even antenna amplifier to improve the receiving effect.
- ④ If the receiver front panel is facing to the operation direction or the receiver is kept in the metal box, put the antenna to the front panel for better receiving effect.
- ⑤ During operation, if the transmitter has the LED lighting up red or flashing green, this means the low power voltage. Please replace battery in time.
- ⑥ If the transmitter will not be used for a long time. Take the battery out to prevent from microphone damaged.
- ⑦ Correctly adjust the distance from transmitter cartridge to the mouth. If the distance is too close, it leads to too much modulation and signal distortion. If too far, it leads to insufficient modulation and less S/N ratio. It is recommended to keep the distance 5~15cm.

### ■ Trouble Shooting

Problem	Reason
Transmitter or receiver has no indication	The transmitter battery is used up. The receiver power supply is not connected well.
Receiver has no RF signal	Transmitter and receiver are not in the same channel or out of the operation range.
There is RF signal but no audio signal	The microphone signal is not sent to the receiver or the receiver has too deep squelch setting.
Too loud audio background noise	The transmission modulation deviation is too small. Too low receiver output level or there is interference signal
Audio signal distortion	The transmitter cartridge is too close to the mouth or the receiver output level is too high.
Short operation range, unstable signal	The receiver has too deep squelch setting, or the antenna is not set well or there is strong electromagnetic interference

If you can not solve the problem, do not disassemble the product by yourself. Contact the local dealer or the factory please.

### ■ Cautions

To avoid electric shock, over temperature, catching fire, explosion, mechanical risk and hurt or property loss caused by improper use, please read the following items carefully before operation:

1. Make sure the power of connected equipment matches with that of this product. Adjust the volume to proper level during operation. Do not operate at high volume level to avoid hearing loss.
2. If abnormal phenomenon (smoke, abnormal smell) happens, please turn off the power switch and disconnect the power plug with power socket, and send the product to local dealer for maintenance.
3. Using battery of broken insulation material is forbidden to avoid short circuit. Do not charge the non-rechargeable battery.
4. Put the waste battery into classification dustbin rather than used as toy by children or discarded directly to avoid potential danger or affecting the environment.
5. The product and accessories should be put in dry and ventilated place rather than humid or dusty environment. Prevent the product from liquid, rain, water, over-colliding, throwing, vibrating, vent hole covered to avoid function destroyed.
6. When the product needs to be installed on wall or ceiling, please fix it tightly to avoid dropping risk.
7. Please abide by safety rules during operation. Do not use the product in the place prohibited by regulation or law to avoid accident.
8. Do not disassemble or repair the product by yourself to avoid hurt. If you have question or need service, please contact the local dealer.

### ■ About the meaning of icon



According to the test results of RL2004 / 108 / EG and European Low Voltage Directive RL2006/95/EG, this product conforms to the limit values stipulated in the directive of the European Community on the integration of the laws of the member states on electromagnetic compatibility.



This symbol indicates that according to WEEE Directive (2012/19/EU) and national laws, this type of waste may have potential harmful substances, which may have negative impact on the environment and human health. All this product should not be disposed together with your household garbage, and should be handed over to the authorized electrical and electronic equipment (WEEE) recycling station for recycling. At the same time, you will help the effective use of natural resources while correctly handling this product. For more information about where you can place waste recycling

注意事项:

1. 本单为保修凭证, 请用户妥善保管, 如有遗失, 恕不保修或退换。

2. 保修期限制: 购买之日起十二个月内。

3. 除了不可抗力事件损坏外, 由本公司负责, 免费维修。

4. 如属保管不善或使用不当造成的损坏, 维修点将酌情收费。

5. 擅自拆卸维修者, 不予保修。

6. 以上保修条款仅限于中国市场适用 (不包含港澳台地区)。

# 产品服务保证书

姓名: \_\_\_\_\_ 电话: \_\_\_\_\_ 地址: \_\_\_\_\_

商品: \_\_\_\_\_ 型号: \_\_\_\_\_ 购买日期: \_\_\_\_\_ 年 \_\_\_\_ 月 \_\_\_\_ 日

维修记录栏(由维修员填写)	维修员签名	日期





扫一扫，了解更多产品

Scan for more

product information

## **广东省电声工程技术研究中心 广东得胜电子有限公司制造**

地址：广东省惠州市博罗县龙溪街道富康一路2号

服务热线：400 6828 333 传真：0752 6383950

邮箱：xs@takstar.com

网址：www.takstar.com

Guangdong Takstar Electronic Co., Ltd.

Address: No. 2 Fu Kang Yi Rd., Longxi Boluo

Huizhou, Guangdong 516121 China

Tel: 86 752 6383644 Fax: 86 752 6383952

Email: sales@takstar.com

Website: www.takstar.com

GB/T 17276-1998

9T00M2RS2A